

The Most **Reliable** Storage For Industries

SV170-μSSD



Overview

SV170-μSSD

Apacer ultra-small 16x20mm SSD-μSSD complies with JEDEC MO-276 specification, a maximum sequential read/write speed of 560/470 MB/sec, which integrates key components such as controller, flash in a single chip using a single ball grid array package (BGA) technology, breaking the traditional size restrictions, and is a great leap forward in terms of technology.

In addition, its characteristics such as wide temperature (-40°C ~+85°C) and surface-mount technology (SMT) provide the most stable storage installation for observation and photography even in high altitude.



Features

- Low-Density Parity-Check (LDPC) Code
- Global Wear Leveling
- Flash Bad-block Management
- Flash Translation Layer: Page Mapping
- S.M.A.R.T.
- Power Failure Management
- ATA Secure Erase
- Device Sleep
- TRIM
- Hyper Cache Technology
- Over-Provisioning

Specifications

Model	SV170-μSSD
Interface	SATA 3.2 (6Gb/s)
Connector	BGA 156 Ball
Form Factor	MO-276
NAND Flash Type	TLC
Capacity	60GB~240GB
Sustained Read Performance (MB/sec)	Up to 560
Sustained Write Performance (MB/sec)	Up to 470
ECC Engine	Built-in 72-bit per 1K bytes LDPC ECC
IOPS (4K Random Write)	Up to 83K
Standard Operating Temperature (°C)	0 ~ + 70
Extended Operating Temperature (°C)	-40 ~ + 85
Storage Temperature (°C)	-40 ~ + 100
Operating Voltage	– 3.3V ± 5% – 1.8V ± 5% – 1.2V ± 5%
Power Consumption	Active mode (max.): 380 mA & Idle mode: 105 mA
Dimension (L x W x H)	16 x 20 x 1.4 (mm)
MTBF (hours)	>1,000,000

Mechanical Specifications

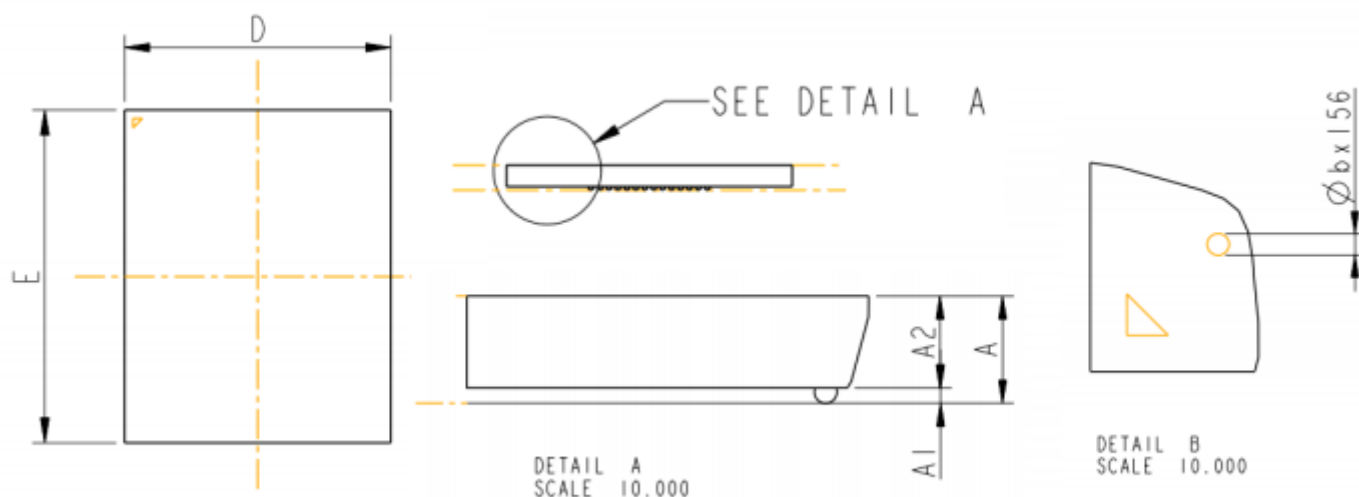

**For more information,
contact your Apacer representative**

Global Presence

Taiwan (Headquarter)
Apacer Technology Inc.
Tel: +886-2-2267-8000

Europe
Apacer Technology B.V.
Tel: +31-40-267-0000

U.S.A.
Apacer Memory America, Inc.
Tel: +1-408-518-8699

China
Apacer Electronic (Shanghai)
Co., Ltd.
Tel: +86-21-6228-9939

Japan
Apacer Technology Corp.
Tel: +81-3-5419-2668

India
Apacer Technologies Pvt. Ltd.
Tel: +91-80-35910296